



26th WPMC

Orlando, Florida

Nov. 28 – Dec. 1, 2023

K.-C. Chen

University of South Florida

kwangcheng@usf.edu

K.-C. Chen for WPMC 2023

Summary of WPMC 2023



- 26th WPMC will be in-person ONLY
- City: Orlando, Florida
 - Tampa is west of Orlando for 75 minutes driving.
 - Convenient flights
- Conference Dates: November 28 (Tuesday) to December 1 (Friday), 2023
 - One working day after Thanksgiving weekend
 - One weekend prior to the IEEE Globecom 2023
- Venue: Two candidates with price quotes (subject to final selection)
 - A. Wyndham
 - B. Rosen

Program



	Nov. 28 (Tue)	Nov. 29 (Wed)	Nov. 30 (Thu)	Dec. 1 (Fri)
9:00-10:30	Tutorials 1-3	Keynotes-1A,1B	Keynotes-2A,2B	Keynotes-3A,3B
10:30-11:00	Coffee Break	Coffee Break	Coffee Break	Coffee Break
11:00-12:30	Tutorials 1-3	Technical Sessions; Online Session-1	Technical Sessions; Online Session-2	Technical Sessions; Online Session-3
12:30-14:00	Lunch	Lunch	Lunch	Lunch
14:00-15:30	Tutorials 4-6	Technical Sessions; Special Session-1	Technical Sessions; Special Session-2	Technical Sessions; Special Session-3
15:30-16:00	Coffee Break	Coffee Break	Coffee Break	
16:00-17:30	Tutorials 4-6	Technical Sessions; Panel-1	Technical Sessions; Panel-2	
18:30-20:30	Welcome Reception	WPMC Steering Committee	Banquet	VIP Dinner

Online sessions are for those who can not get the visa

160 regular papers
15 online presentations



TECHNICAL SYMPOSIA

RF, Optical, Spectrum Technology

- Antennas and RF Techniques
- Ultra-Wideband, Millimeter-Wave, and Terahertz
- Next Generation MIMO and Massive MIMO
- Waveforms and Modulation
- Channel Modeling and Estimation
- Smart Radio Environment
- Optical Communication
- Visible Light and Wireless Optical Communication
- Reconfigurable Intelligent Surface
- Signal Processing and Integrated Circuits
- Spectrum Sharing/Coexistence

Wireless Networks

- Ad-hoc Networks
- Vehicular Networks
- 802.11 and Next-generation Wi-Fi
- UAVs and NonTerrestrial Networks
- Software Defined Radio and Networks
- Networking Architectures for Artificial Intelligence
- Local 5G/6G Systems
- Data Science and AI for Wireless Networks
- Resource Management

International Standards, Multimedia, Social Media, Application Services and Applications

- Experiments, Prototypes, and Testbeds
- Sensing and Localization
- O-RAN
- 5G and 6G Standardization
- Networking Support for Virtual and Augmented Reality
- Network Economics
- Mobile Social Media and Social Networks
- Holographic Communications
- Video and Multimedia Coding

Wireless Communications Systems

- Advanced Modulation Schemes
- Cooperative and Relay-aided Communications
- Interference Management, Alignment, and Cancellation
- Cross-Layer Optimization
- Massive Communication and Information Theory
- Multiple Access
- Equalization, Channel Estimation, Synchronization
- Error Correcting Codes
- Satellite and Deep Space Communications
- Machine Learning for Wireless Communications
- Game-Theoretic Approaches to Wireless

Security and Privacy in Communications

- Applied Cryptography for Cyber, Information, and Network Security
- Public Key Infrastructures and Authentication Protocols
- Communication Privacy and Anonymity
- Blockchain Security
- Malware Detection and Damage Recovery
- Network Intrusion Detection and Prevention, Firewalls, Packet Filters
- Key Management and Credential Management
- Cloud, Data Center and Distributed Systems Security
- Quantum Communications and Networks

IoT, Sensor Networks, and AI-Enabled Networks

- IoT and Machine Type Communications
- E-health and Mobile Health
- Innovative Implanted and Wearable Devices
- Convex and Non-Convex Optimization for Wireless
- Bayesian Optimization for Wireless
- End-to-end ML over Wireless Channels
- Communication-inspired Machine Learning (ML)
- Edge Computing, Edge Intelligence and Fog Networks
- Green Communications and Networks
- Machine-to-machine Communication
- Smart Factory, Smart Community

IMPORTANT DATES

Technical Paper Submissions: July 1, 2023

Workshop/Tutorial Proposal: July 1, 2023

Notification of Acceptance: September 15, 2023

Camera Ready Submissions: October 15, 2023

October 31, 2022

Venue A: Wyndham Lake Buena Vista



- Walking to Disney Springs
 - many shops including huge Disney Shop, Lego, many restaurants
- Shuttle bus to Disney World
- A few nearby golf courses
- No need of car rental to move around
- Lower room rate, \$125
 - Food and drink with higher price



Meeting Space (I)



Horizons Ballroom & Solar Room
(mezzanine level)

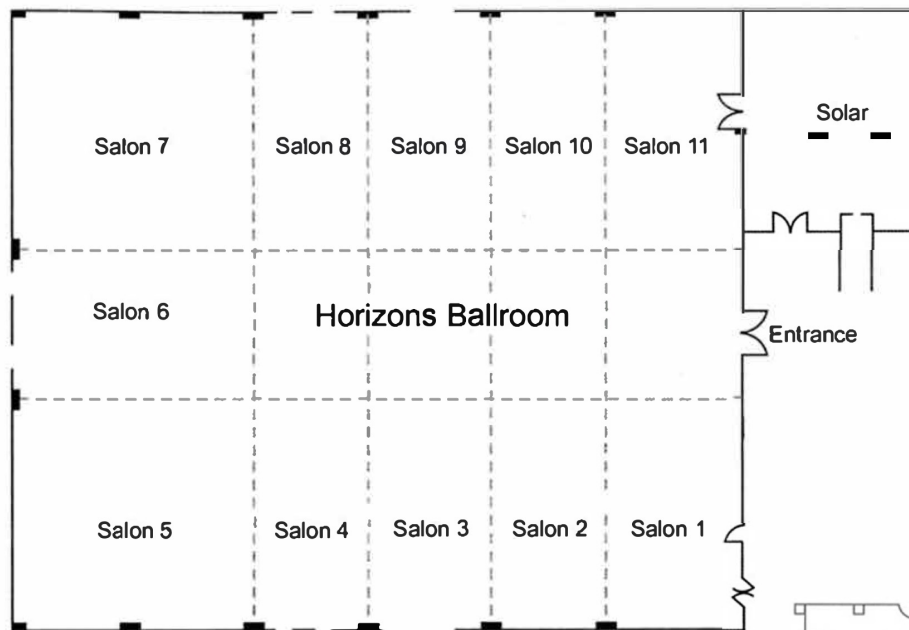



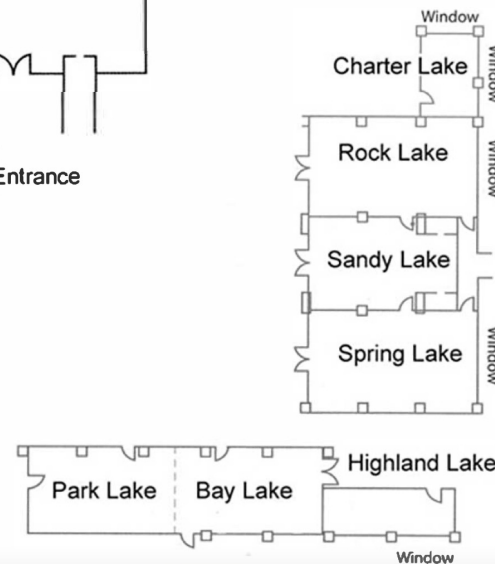





Lakes Conference Center
(lobby level)



Meeting Space (II)



	 Space	 Ceiling Ht.	 Size	 U-Shape	 Banquet	 Reception	 Theater	 Class	 Board
Horizons Ballroom	12,000 Sq. Ft.	15.00 Ft.	100' x 120'	-	1,000	1,200	1,200	800	-
Horizons Salon 1-4, 6, 8-11	800 Sq. Ft.	15.00 Ft.	40' x 20'	24	50	80	80	40	25
Horizons Salon 5 & 7	1,600 Sq. Ft.	15.00 Ft.	40' x 40'	36	100	160	160	80	40
Solar	1,050 Sq. Ft.	12.00 Ft.	30' x 35'	24	50	80	80	35	20
Bay/Park	1,240 Sq. Ft.	12.00 Ft.	62' x 20'	36	80	120	100	70	40
Bay Lake	620 Sq. Ft.	12.00 Ft.	31' x 20'	18	40	60	50	35	20
Park Lake	620 Sq. Ft.	12.00 Ft.	31' x 20'	18	40	60	50	35	20
Rock Lake	720 Sq. Ft.	12.00 Ft.	36' x 20'	24	50	75	75	45	25
Sandy Lake	640 Sq. Ft.	12.00 Ft.	32' x 20'	18	40	65	50	35	25
Spring Lake	720 Sq. Ft.	12.00 Ft.	36' x 20'	24	50	75	75	45	25
Highland Lake Boardroom	260 Sq. Ft.	12.00 Ft.	26' x 10'	-	-	-	-	-	14
Charter Lake Boardroom	228 Sq. Ft.	12.00 Ft.	19' x 12'	-	-	-	-	-	12



Backup 1 of Venue A:

- HILTON ORLANDO BUENA VISTA PALACE DISNEY SPRINGS AREA

- **MEETING & EVENT HIGHLIGHTS**

- Located steps away from Disney Springs®
- 108,000 sq. ft. of modern, flexible meeting space
- 3 Modern Ballrooms with pre-function space
- 42 Breakout Meeting Rooms
- Exquisite outdoor function venues featuring private patios and Event Lawn
- Exclusive access to Disney Theme Park venues, Disney Event Group and The Disney Institute for your meeting or event
- The latest IT Infrastructure supported by PSAV





Backup 2 of Venue A:

- [Sheraton Orlando Lake Buena Vista Resort](#)
- Max 18 meeting rooms
- Max capacity 900 persons
- 31,916 square-feet meeting space



Magic Kingdom

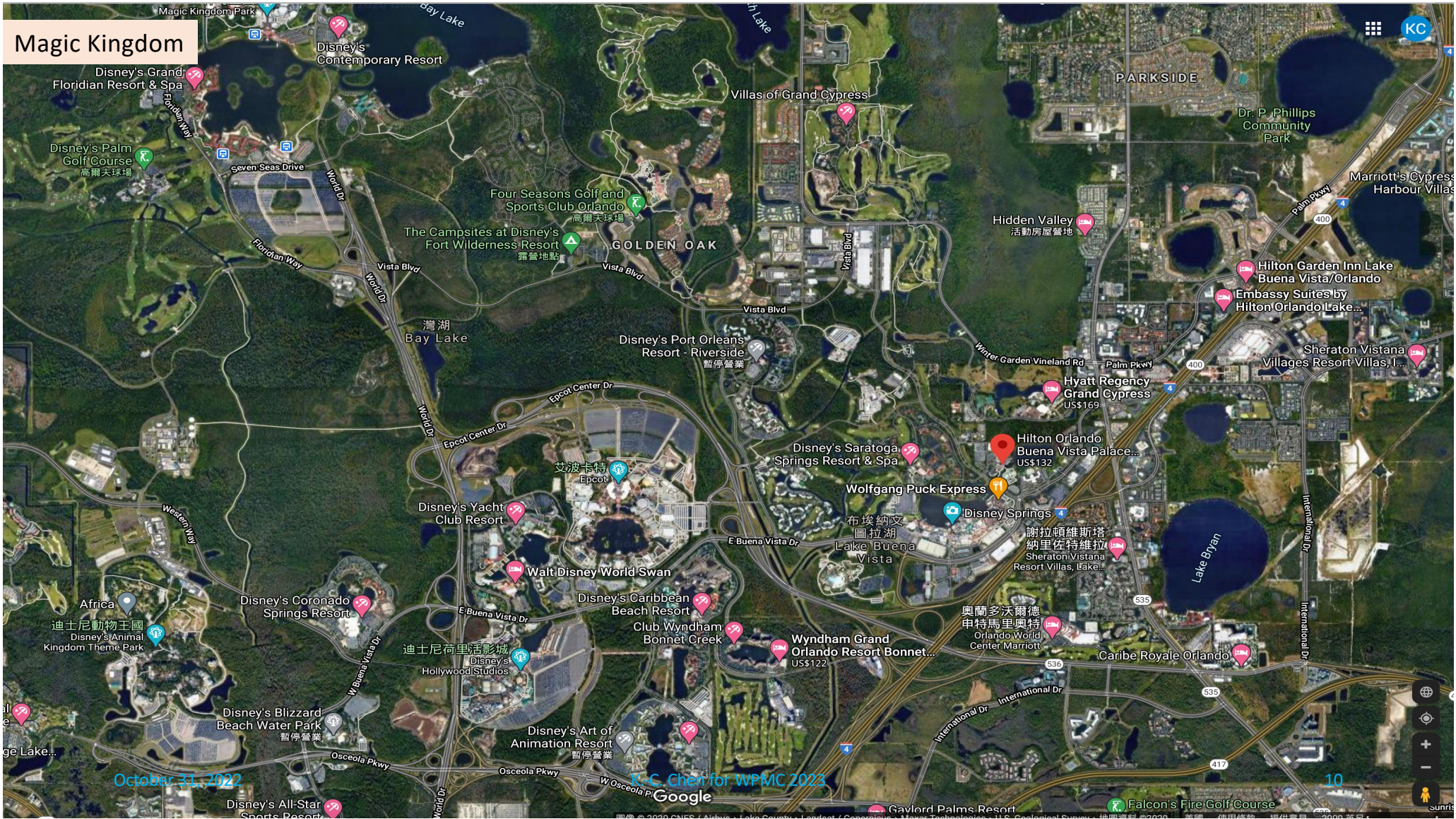

October 31, 2022

R-C Chen for WPMC 2023

Google

Image © 2022 CNES / Airbus, Lake County, Florida / Copernicus, Mapbox, OpenStreetMap contributors, US Geological Survey, 地圖資料 © 2022 美國 使用條款 提供資料 2020 英尺



Venue B: Rosen Shingle Creek

- Large number of rooms and huge area of meeting facilities (in a separate wing of the building)
 - Capable of hosting GLOBECOM
 - > 1,000 rooms
 - \$169/night
 - Free meeting space with \$40,000 drink & food
- Hotel with own golf course and sporting facilities
 - Close to Universal Studio
- Must take transportation to nearby locations
 - Dinners outside are more challenging

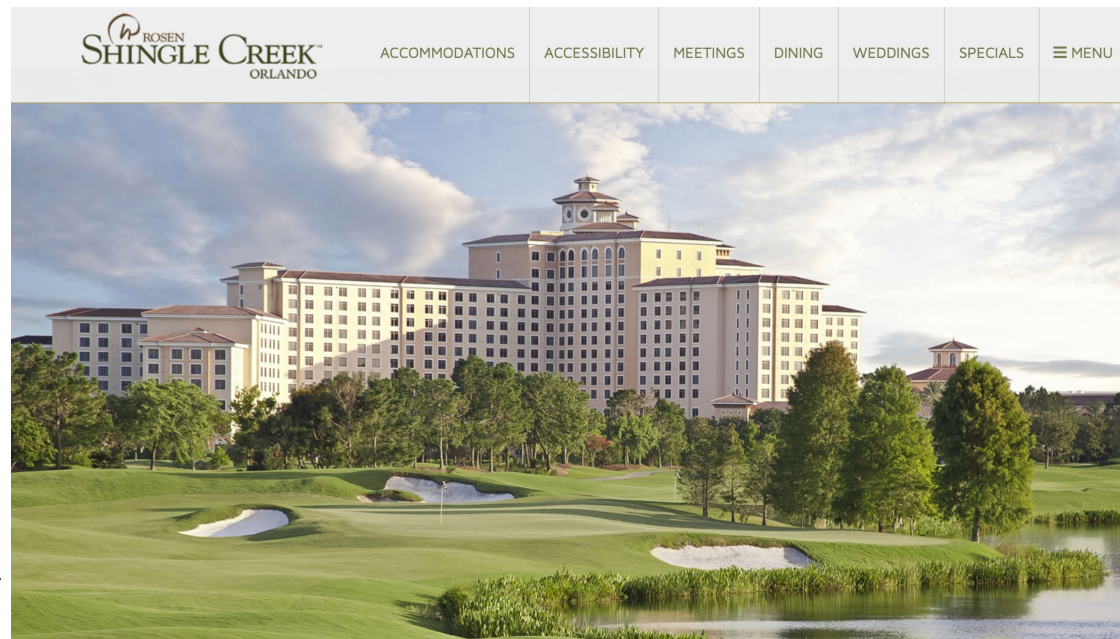

Meeting Space



Level 2 Meeting Room Capacities

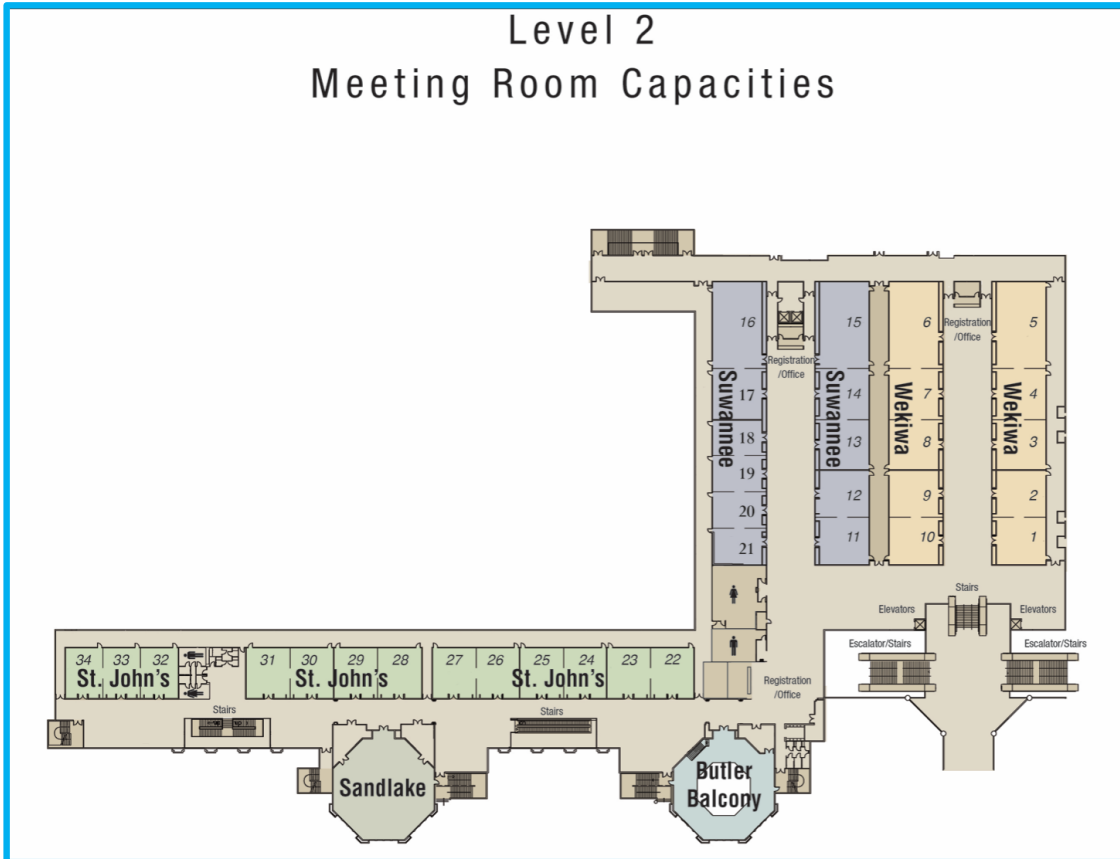

Level 1 is too big to host WPMC

Personal Visit



October 31, 2022

Backup of Venue B:

- **Wyndham Orlando Resort International Drive**
- 60,000 sq ft convention center
- 613 rooms
- Location slightly away (5 minutes more driving) from points of interest
 - Closer to premium outlet
 - Less attractive neighborhood

October 31, 2022



K.-C. Chen for WPMC 2023

14

VIP Dinner

- KC's home in Tampa, Florida
 - 75 minutes considering normal traffic delay
 - Bus leaving 3:15 pm, Dec. 1, Friday
 - 4:45 – 7:45 pm, buffet dinner
 - 8:00 pm back to conference hotel, estimated arrival time 9:15 pm
 - It is a big nature lake, and there are alligators





K.-C. Chen for WPMC 2023



October 31, 2022



Entertainment

more choices than
Disney World,
Universal Studio,
Sea World, etc.

Budget



Income:			
full registration (full)	\$650	90	\$58,500
full registration (late)	\$750	10	\$7,500
student registration	\$400	40	\$16,000
tutorial only	\$150	10	\$1,500
exhibition	\$2,000	4	\$8,000
NICT in-kind			\$30,000
patronage	\$5,000	2	\$10,000
Total			\$131,500

- One full registration can have two papers
- Lunch for every participant

Expenses:			
EDAS	\$15	400	\$6,000
web site design & maintenance			\$2,000
Keynotes	\$1,500	6	\$9,000
Tutorial Speakers	\$750	6	\$4,500
gifts to volunteers	\$100	60	\$6,000
student travel grants	\$600	10	\$6,000
coffee breaks	\$3,600	7	\$25,200
lunches	\$6,000	4	\$24,000
Banquet	\$120	150	\$18,000
welcome reception	\$60	150	\$9,000
WPMC Steering Committee	\$120	25	\$3,000
program printing, decrodaton, room AV, WiFi			\$9,500
gifts, USB, holders to registrants			\$8,000
organization services			\$9,000
tranporation			\$6,000
Total			\$130,200



Thank you and questions?

October 31, 2022

K.-C. Chen for WPMC 2023

18